**FAG****6002-H-2RSR**

Deep groove ball bearing

Schaeffler ID:
0938753800000Deep groove ball bearing 60...H-2RSR,
single row, H-Series, seals, steel sheet
metal cage

Technical information

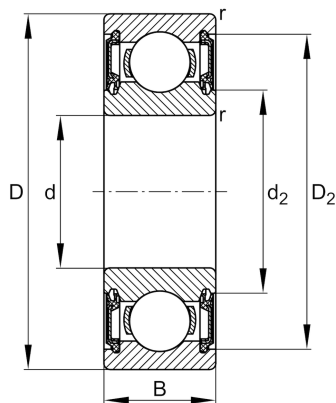

Main Dimensions & Performance Data

d	15 mm	Bore diameter
D	32 mm	Outside diameter
B	9 mm	Width
C _r	5.850 N	Basic dynamic load rating, radial
C _{0r}	2.850 N	Basic static load rating, radial
C _{ur}	172 N	Fatigue load limit, radial
n _G	13.100 1/min	Limiting speed
	0,033 kg	Weight

Dimensions

r _{min}	0,3 mm	Minimum chamfer dimension
D ₂	27,98 mm	Caliber diameter outer ring
d ₂	19,8 mm	Caliber diameter inner ring

Mounting dimensions

d _{a min}	17 mm	Minimum diameter shaft shoulder
D _{a max}	30 mm	Maximum diameter of housing shoulder
r _{a max}	0,3 mm	Maximum fillet radius

Calculation factors

f ₀	14	Calculation factor
----------------	----	--------------------

Temperature range

T _{min}	-20 °C	Operating temperature min.
T _{max}	100 °C	Operating temperature max.

